

A.B. Ellis Public School and Espanola High School



Revitalization
May 15, 2014

Agenda

Site Layout Option

Data

Floor Plan

Construction Phase-in Schedule

Existing Site Plan

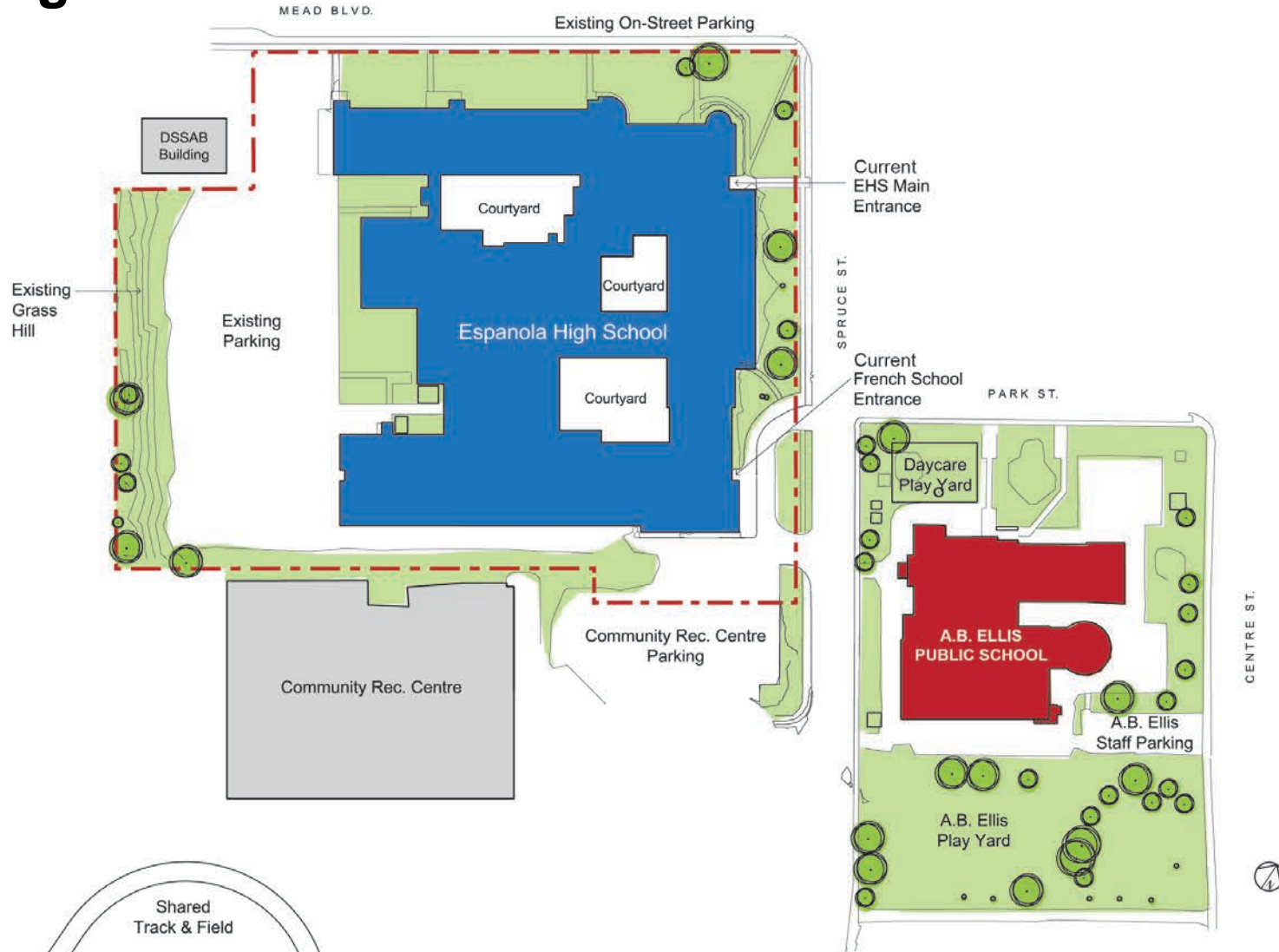

Proposed Layout - Option 1



Proposed Layout - Option 2



Data for New A.B. Ellis Public School and Espanola High School

- School administrative teams for both A.B. Ellis PS and Espanola HS
- Separate entrances and bus drop off for A.B. Ellis PS and Espanola HS
- Right size building from 159,865 sq.ft. to 147,675 sq.ft.
- A combined staff of 92 (including daycare and custodial staff)
- Total of 159 parking spaces between A.B. Ellis PS site/Espanola HS site
- 65,420 sq.ft. of play area (increase of approximately 20,000 sq.ft.)
- Full daycare space consisting of three rooms plus a hub
- Accessibility for Ontarians with Disabilities Act (AODA) full compliance

Enrolment

A.B. Ellis Public School

- Current capacity 497 students
- Current enrolment is approximately 280 students
- Predicted enrolment at October 2014 is 288 students
- New capacity is approximately 309 students

Espanola High School

- Current capacity 867 students with École secondaire catholique Franco-Ouest within Espanola High School and 1077 students without École secondaire catholique Franco-Ouest.
- Current enrolment is approximately 550 students
- Predicted enrolment at October 2014 is 534 students
- New capacity is approximately 642 students

Espanola High School Proposed Layout – Ground Floor

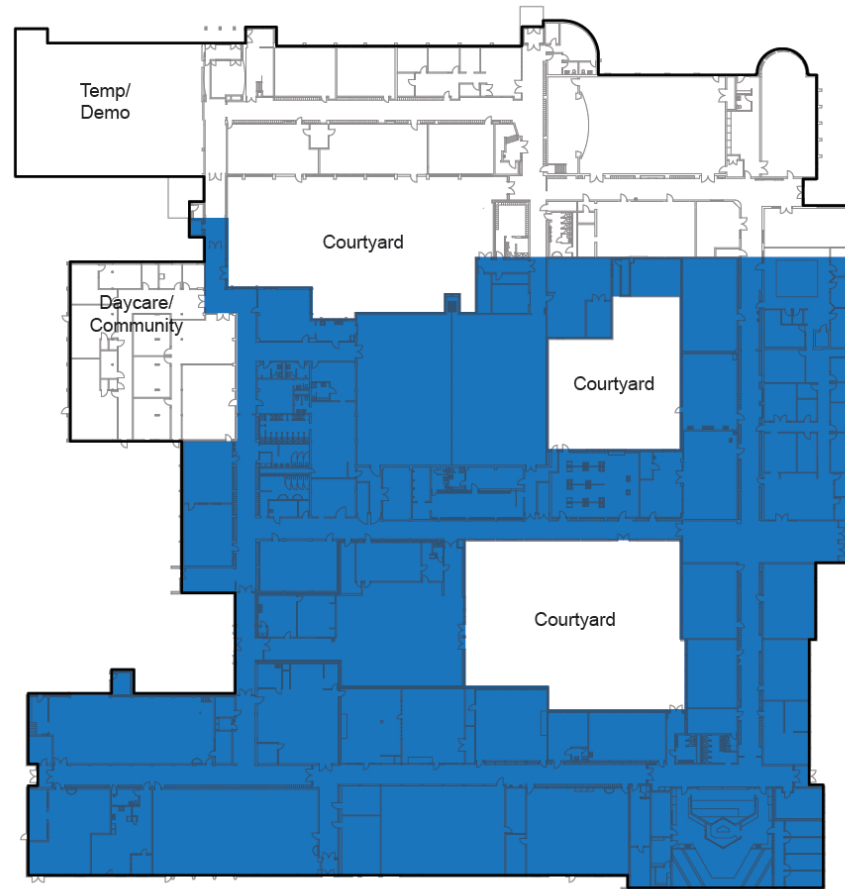

A.B. Ellis Public School Proposed Layout – Ground Floor

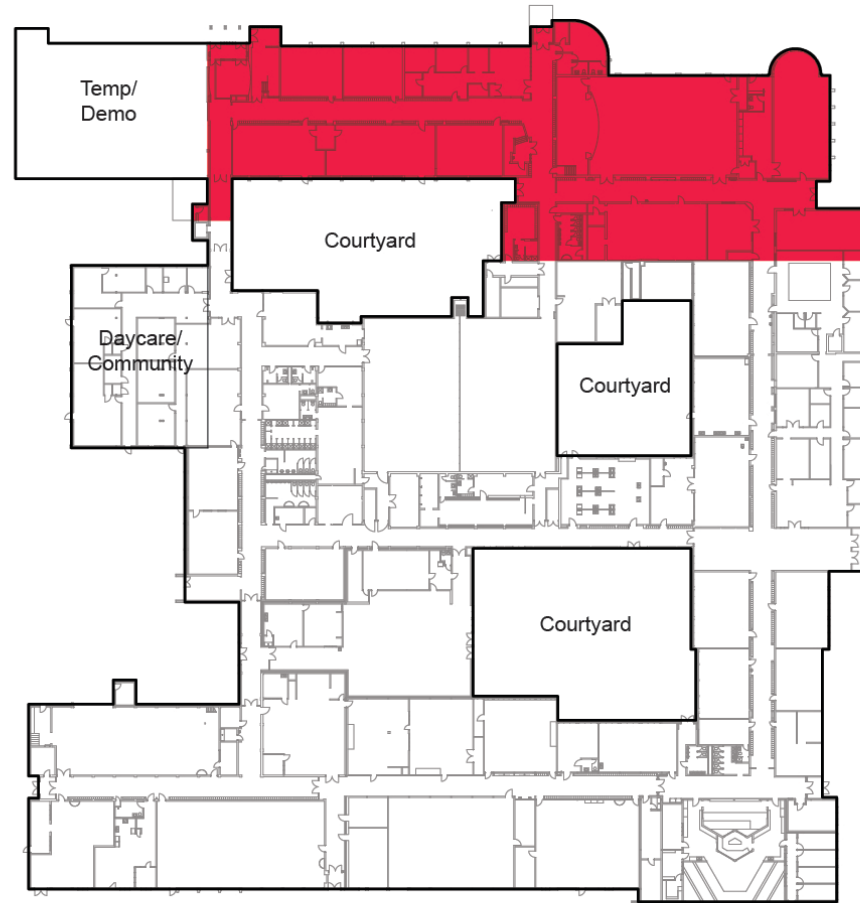



Espanola High School Proposed Layout – Second Floor

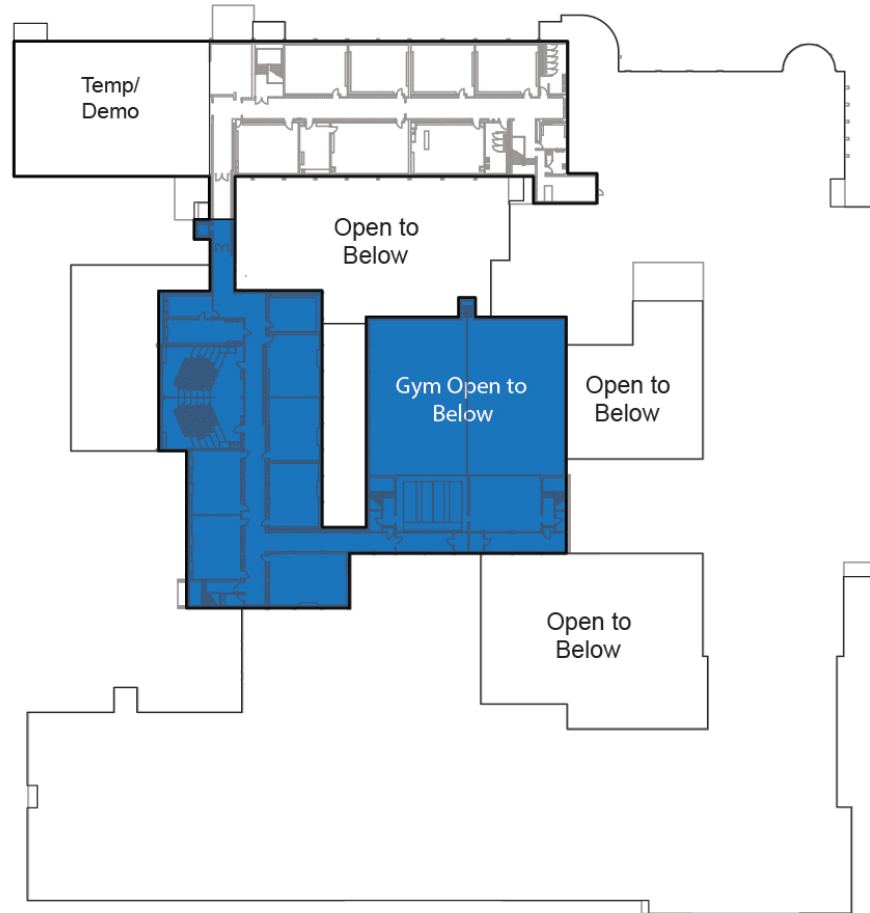

A. B. Ellis Public School Proposed Layout – Second Floor

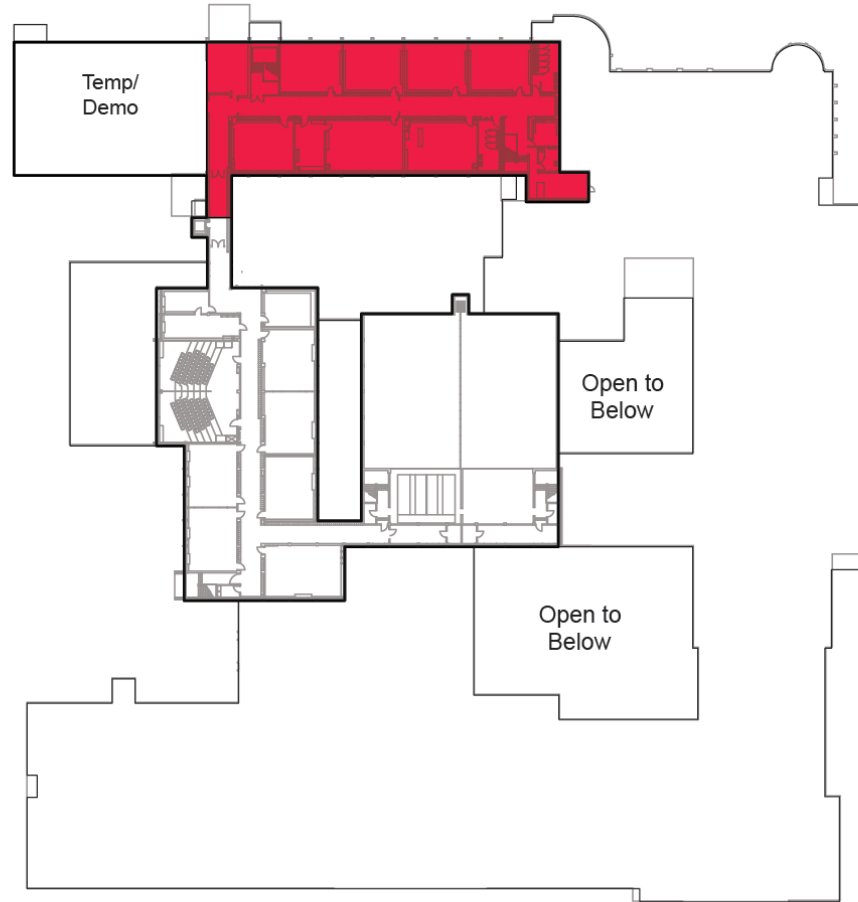

Construction Phase – In Schedule

Begin construction on Espanola HS – Summer 2014

Anticipate completion of revitalization of Espanola HS – Winter 2014-2015

Begin construction of the new A.B. Ellis PS – Winter 2014-2015

Anticipate completion of the new A.B. Ellis PS - Fall 2015

Anticipate completion of demolition and site work - Summer 2016-2017



We welcome your comments at...

espanola@rainbowschools.ca